

DEUER

QS-9000

MANUFACTURING INCORPORATED

Dayton, Ohio USA

WEBSITE www.deuer.com

(866) 489-MULE (6853)

PART NO.	DESCRIPTION	No. Required
MP-120	SLIP HOOK	3
MP-121	ADJUSTMENT KNOB AND BOLT ASSEMBLY	1
MP-124	PLASTIC STORAGE CASE	1
MP-140	STOP PAWL SPRING	1
MP-143	DRIVE PAWL ASSEMBLY	1
MP-166	RATCHET WHEEL ASSEMBLY	1
MP-171	STOP PAWL & LEVER ASSEMBLY	1
MP-173	SLEEVE & BOLT ASSEMBLY (LONG)	1
MP-174	SLEEVE & BOLT ASSEMBLY (SHORT)	1
MP-175	CONTROL SPRING WITH COVER	1
MP-176-3	CLEVIS PIN WITH COTTER PIN (25/32)	1
MP-204	CLEVIS	1
MP-302	HANDLE ASSEMBLY WITH GRIP	1
MP-304	DRIVE PAWL SUPPORT ASSEMBLY	2
MP-306	FRAME COMPONENTS ASSEMBLY	1
MP-21210	CABLE ASSEMBLY, 5/32 DIA. X 10' LONG	1

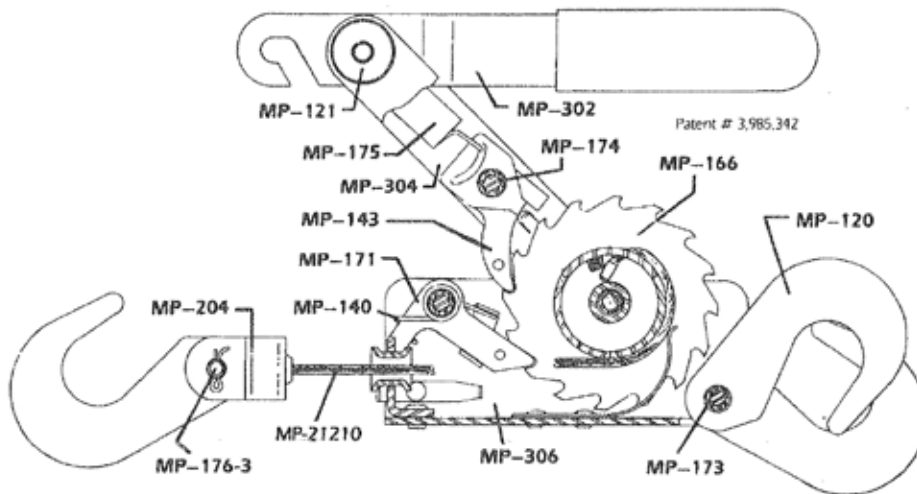

THIS IS YOUR



HOIST-PULLER

LIMITED SIX (6) MONTH WARRANTY TO ORIGINAL USING BUYER

All Pack-Mule Hoist/Pullers, when operated under normal conditions, within their rated capacities, and in accordance with the instructions received with the product are warranted against defects in materials or workmanship for six months from date of purchase by the original using buyer.

Any part or unit recognized as defective by Deuer Mfg. will be repaired or replaced without charge during this period, if it is returned, prepaid, to the factory with a copy of the original sale receipt.

This warranty shall not apply if the unit has been altered, repaired or modified outside the warrantor's factory or if the cable has been frayed or broken due to misuse such as being bent over sharp corners or wrapped around an object and hooked back on itself. This warranty does not cover any claim for labor, delays or damages. While this warranty gives you specific legal rights, you may also have other rights which vary from state to state.

Anthony Howard

Packed and inspected by _____



OPERATING INSTRUCTIONS

- 1. TO READY PULLER FOR OPERATION**—Rotate handle about pivoting bolt until it is in-line with the drive pawl supports and pull up to seat the support stud in the bottom of the handle slot. Then secure the handle in the extended position by tightening the locking knob.

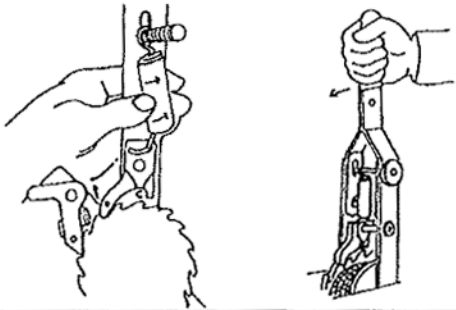
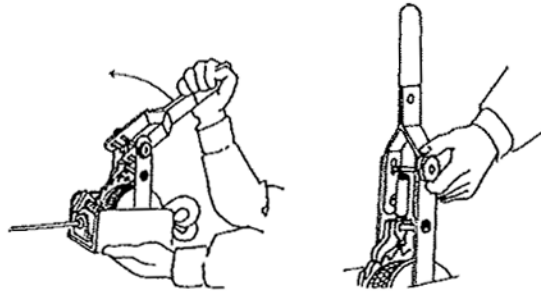

- 2. TO APPLY CABLE TENSION**—Push black plastic-covered spring, located within handle, towards scissored hooks to engage drive pawl. Then pivot handle back and forth to rotate ratchet wheel, making sure that the stop pawl is engaging the ratchet teeth.

- 3. TO RELEASE CABLE TENSION**—Push black plastic-covered spring towards cable exit end to disengage drive pawl. Pivot handle towards the cable exit end until it contacts the stop pawl. Then continue applying pressure against the stop pawl until it momentarily disengages, allowing the ratchet wheel to release one notch. Repeat handle motion to continue releasing cable tension a notch-at-a-time.

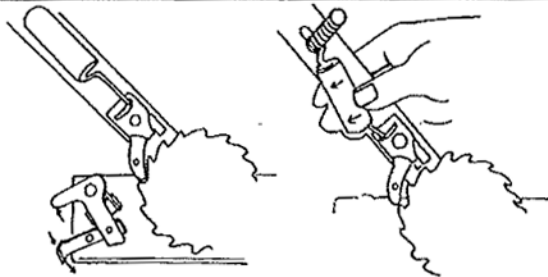
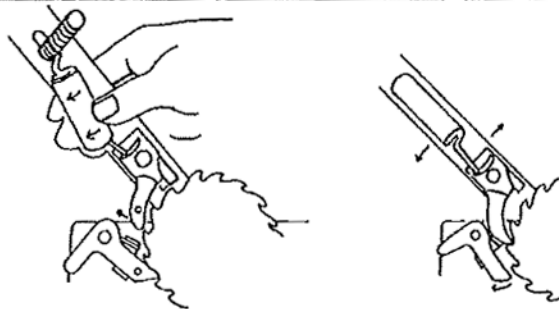

- 4. TO FREE WHEEL SPOOL**—Disengage both the drive pawl and stop pawl. The stop pawl can be held out of engagement for remote attachments by pivoting the free wheeling latch into position.

CABLE REPLACEMENT

UNIQUE QUICK-CHANGE DESIGN—A "keyhole" opening of special design in the barrel of the ratchet wheel and a swaged end to the cable permit instant, secure replacement of the cable. Pull all the cable off the ratchet wheel. Snap old cable out of "keyhole". Snap in new cable. Rewind cable on ratchet wheel.

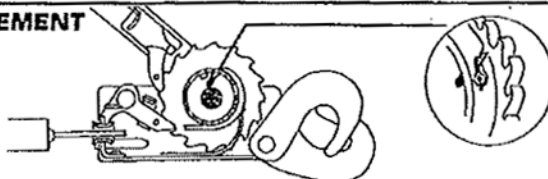

CAUTION

1. Read and understand the Operation Instructions on your Pack-Mule Hoist/Puller before using.
2. Do not exceed rated or specified load limits.
3. Do not subject Pack-Mule Hoist/Puller to sudden shock loads.
4. Operate the Pack-Mule Hoist/Puller with manual power only.
5. Do not use Pack-Mule Hoist/Puller as, or in place of a tow cable.
6. Use the Pack-Mule Hoist/Puller for straight pulling or lifting only. Do not side load.
7. Always have a minimum of 2 wraps of cable on the drum.
8. Never stand in front of – or in line with a pretensioned unit.
9. Do not use extension bar on handle.
10. Do not operate Pack-Mule Hoist/Puller with frayed, kinked, twisted or damaged cable.
11. Do not lift people or loads over people.
12. Do not wrap cable over any sharp edge or secure any object by bringing hook back onto cable.